

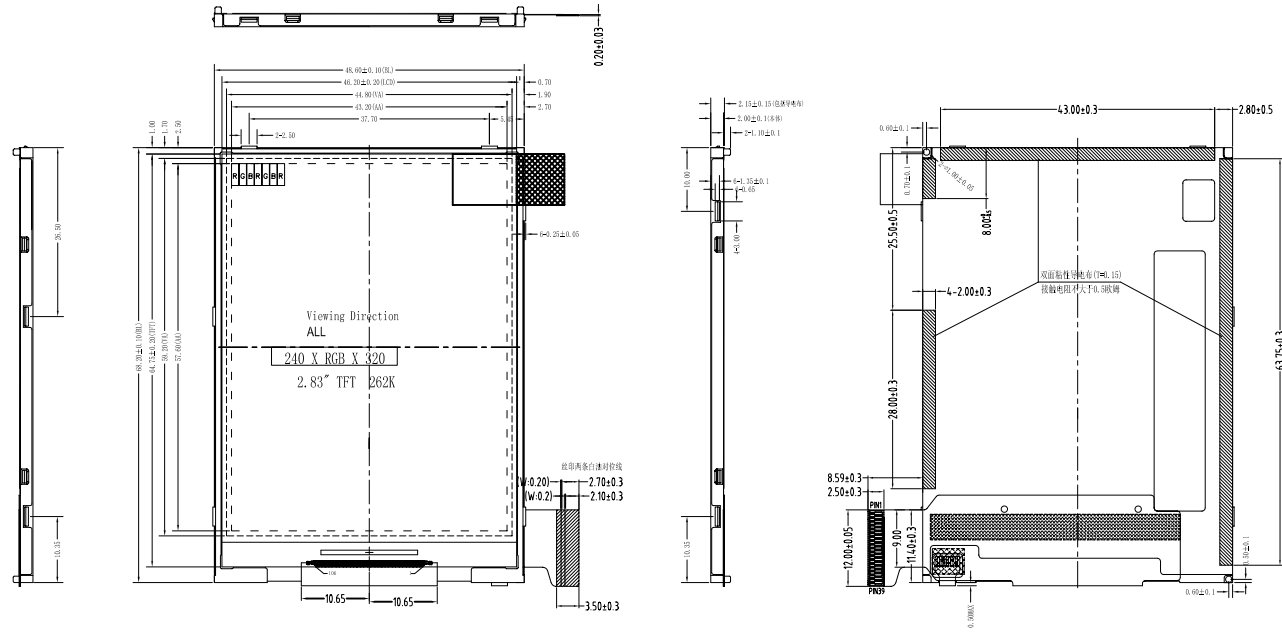

# MODULE NO.: MI0283WT-1

Ver 1.0



1	GND	21	D10
2	LEDA	22	D11
3	LEDK1	23	D12
4	LEDK2	24	D13
5	LEDK3	25	D14
6	LEDK4	26	D15
7	GND	27	D16
8	VCC	28	D17
9	IOVCC	29	GND
10	GND	30	RD
11	D0	31	WR
12	D1	32	RS
13	D2	33	CS
14	D3	34	FLM
15	D4	35	RESET
16	D5	36	GND
17	D6	37	VSS
18	D7	38	IM3
19	D8	39	LMO
20	D9		

MATCHING CONNECTOR :XF3H-3955-31A

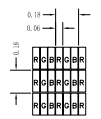

Detail A

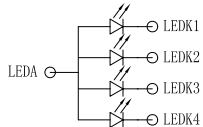

CIRCUIT DIAGRAM

- NOTES:
1. DISPLAY TYPE: 2.83" 262K TFT, TRANSMISSIVE
  2. MAIN LCD DRIVER: HX8347D
  3. ROHS-COMPLIANCY
  4. BACKLIGHT: 4 CHIP-WHITE LED, PARALLEL CONNECTION
  5. OPERATING TEMP: -20° C ~ 70° C  
STORAGE TEMP : -30° C ~ 80° C
  6. LCM LUMINANCE : 290cd/m2 (avg), (20mA/LED)  
TOLERANCE OF SEGMENTS TO EDGE OF GLASS: ±0.2mm